

RER6-1400

RER6-1400,
Maxium payload 6 kg with maxium reach 1433 mm.

Highlights

A comprehensive arc welding process software can be integrated to meet the requirements of automatic welding in various scenarios;
Available version for the education industry with disassembly possibility to meet the education requirements with intelligent manufacturing focus.

Applications

It can be used in handling, machine tending, arc welding, etc.

Industries

Suitable for plastic, metal parts, education and other industries.



RUNDE

SPECIFICATIONS

Model	RER6-1400	
Type	Articulated	
Controlled axes	6 Axes	
Max. payload on wrist	6 kg	
Repeatability	±0.05 mm	
Robot weight	145 kg	
Reach	1433 mm	
Robot IP grade	IP54 /IP67 (Wrist)	
Cabinet IP grade	IP54	
Drive mode	AC servo drive	
Installation	Floor, Upside-down, Wall, Angle	
Installation environment	Ambient temperature	0~45 °C
	Ambient humidity	RH≤80% (No dew nor frost allowed)
	Vibration acceleration	4.9 m/s ² (<0.5 G)

Allowable load moment at wrist	J 4	12 N·m
	J 5	12 N·m
	J 6	6 N·m
Allowable load inertia at wrist	J 4	0.4 kg·m ²
	J 5	0.4 kg·m ²
	J 6	0.2 kg·m ²
Maximum speed	J 1	175°/sec
	J 2	175°/sec
	J 3	185°/sec
	J 4	330°/sec
	J 5	360°/sec
	J 6	600°/sec
Motion range	J 1	±165°
	J 2	+75°/-135°
	J 3	+170°/-83°
	J 4	±180°
	J 5	±130°
	J 6	±360°

OPERATING SPACE

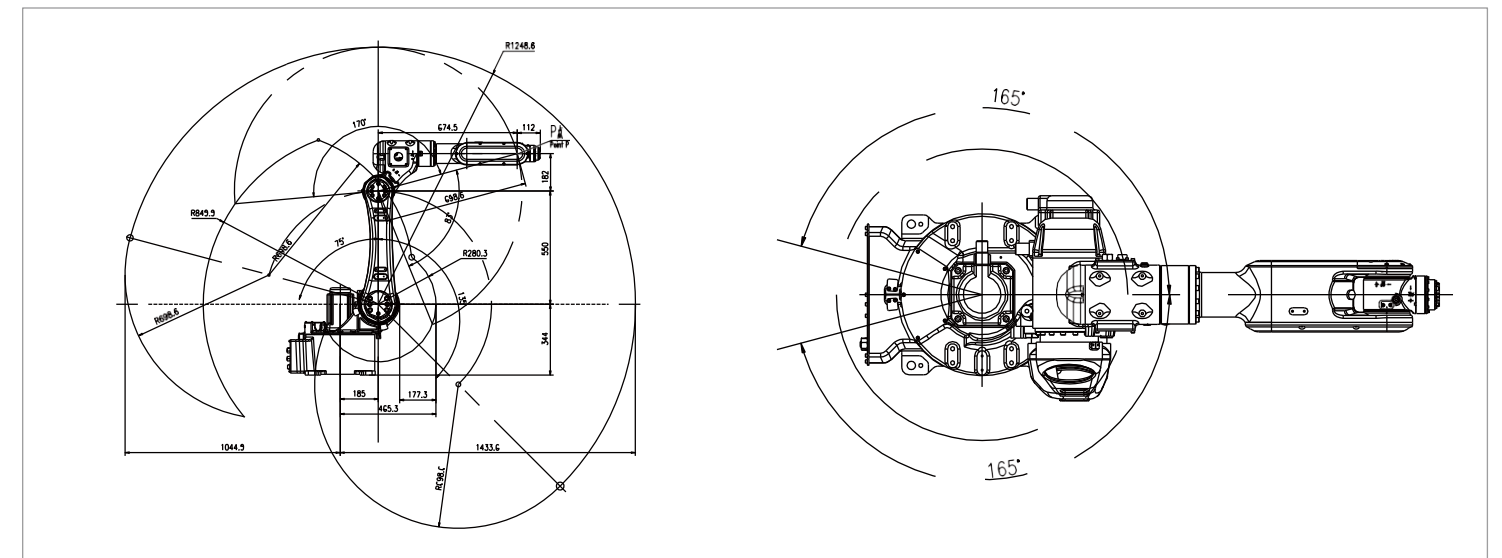

BASE MOUNTING SIZE

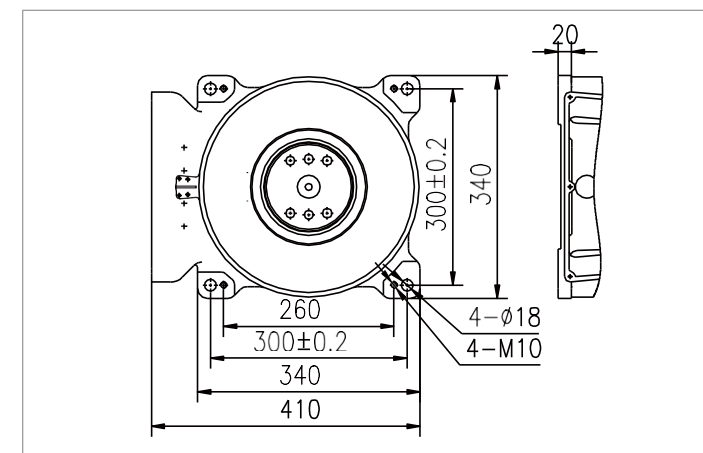

END FLANGE MOUNTING SIZE

