

# RER6-2000

RER6-2000,  
Maxium payload 6 kg with maxium reach 2010 mm.

## Highlights

A comprehensive arc welding process software can be integrated to meet the requirements of automatic welding in various scenarios;  
Special design of robot fore arm, helps customers easily handle complex surface objects, such as painting of sanitary ware and welding of steel structure.

## Applications

It can be used in handling, painting, machine tending, arc welding, etc.

## Industries

Suitable for ceramics, plastic, metal parts, education and other industries.



**RUNDE**

## SPECIFICATIONS

Model	RER6-2000	
Type	Articulated	
Controlled axes	6 Axes	
Max. payload on wrist	6 kg	
Repeatability	±0.05 mm	
Robot weight	195 kg	
Reach	2010 mm	
Robot IP grade	IP54 / IP67 (Wrist)	
Cabinet IP grade	IP54	
Drive mode	AC servo drive	
Installation	Floor, Upside-down, Wall, Angle	
Installation enviroment	Ambient temperature	0~45 °C
	Ambient humidity	RH≤80% (No dew nor frost allowed)
	Vibration acceleration	4.9 m/s <sup>2</sup> (<0.5 G)

Allowable load moment at wrist	J 4	12 N · m
	J 5	12 N · m
	J 6	6 N · m
Allowable load inertia at wrist	J 4	0.4 kg · m <sup>2</sup>
	J 5	0.4 kg · m <sup>2</sup>
	J 6	0.2 kg · m <sup>2</sup>
Maximum speed	J 1	160° /sec
	J 2	160° /sec
	J 3	160° /sec
	J 4	300° /sec
	J 5	300° /sec
	J 6	500° /sec
Motion range	J 1	±165°
	J 2	+80° /-135°
	J 3	+155° /-81°
	J 4	±180°
	J 5	±130°
	J 6	±360°

## OPERATING SPACE

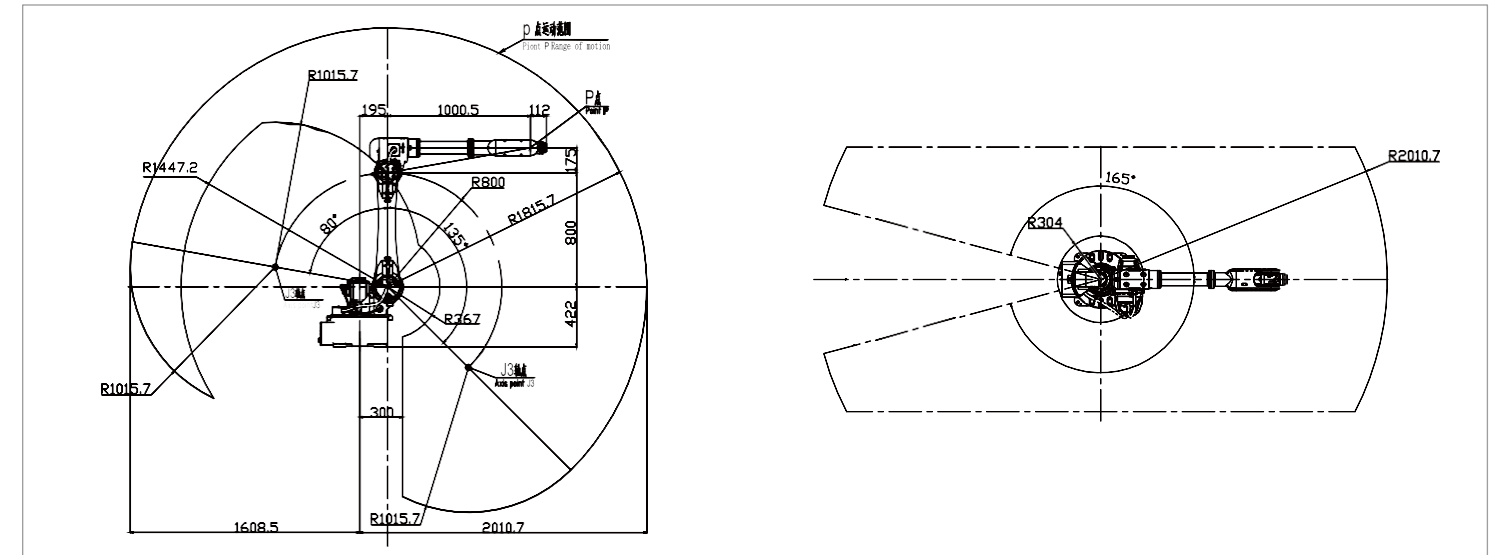

## BASE MOUNTING SIZE

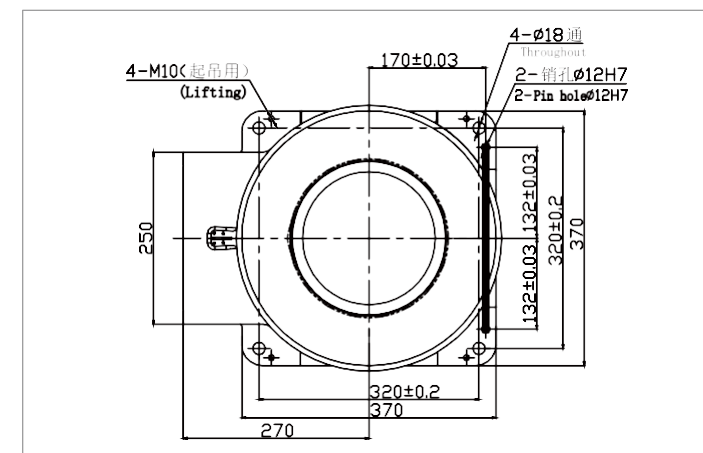

## END FLANGE MOUNTING SIZE

