

RER10-3-900

RER10-3-900,
Maxium payload 10 kg with maxium reach 860 mm.

- Highlights
High inertia design of the robot wrist greatly improves the stability in high-speed movement. It plus advanced kinematic algorithms, helps the task improved by 25%;
Thanks to industry-leading joint seal construction and leakage prevention design, the robot can help customers easily face various scenarios with high cleanliness requirements.
- Applications
It can be used in handling operations.
- Industries
Suitable for PCB, 3C, plastic, metal parts, and other industries.



SPECIFICATIONS

Model	ER10-3-900
Type	Articulated
Controlled axes	3 Axes
Max. payload on wrist	10 kg
Repeatability	±0.05 mm
Robot weight	30 kg
Reach	860 mm
Robot IP grade	IP54
Cabinet IP grade	IP20
Drive mode	AC servo drive
Installation	Upside-down

Installation environment	Ambient temperature	0~45 °C
	Ambient humidity	RH≤80% (No dew nor frost allowed)
	Vibration acceleration	4.9 m/s² (<0.5 G)
Allowable load moment at wrist		J 3 20 N·m
Allowable load inertia at wrist		J 3 1.5 kg·m²
Maximum speed	J 1	300°/sec
	J 2	320°/sec
	J 3	380°/sec
Motion range	J 1	±130°
	J 2	+250°/-69°
	J 3	±130°

OPERATING SPACE

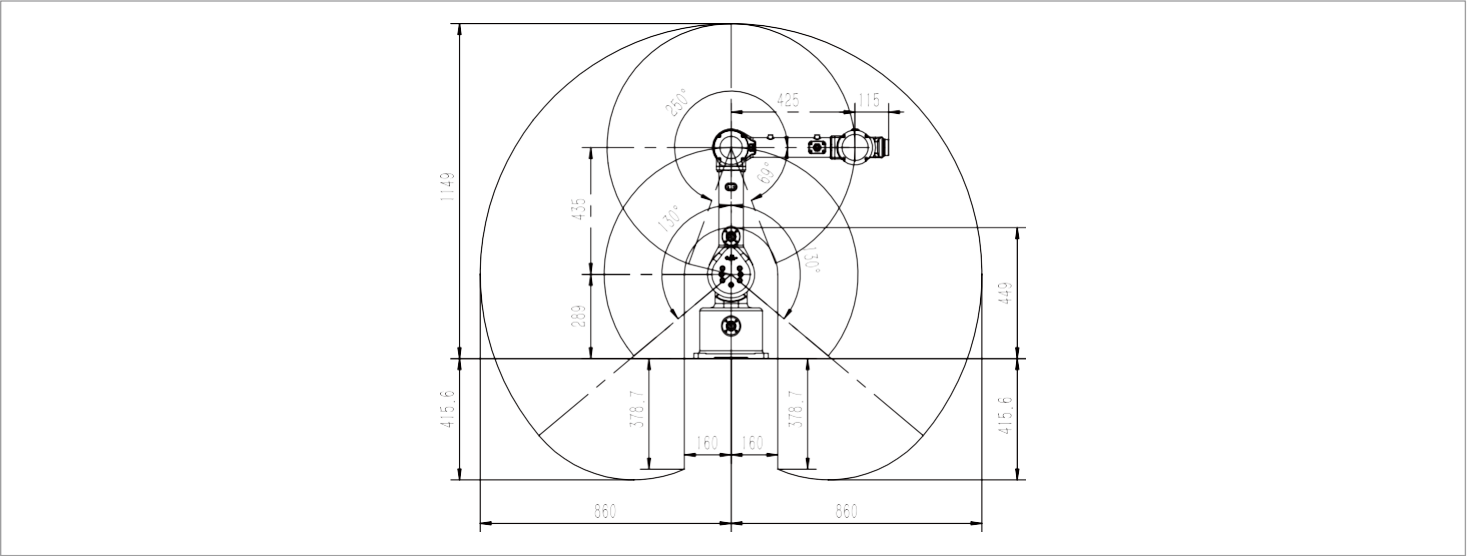

BASE MOUNTING SIZE

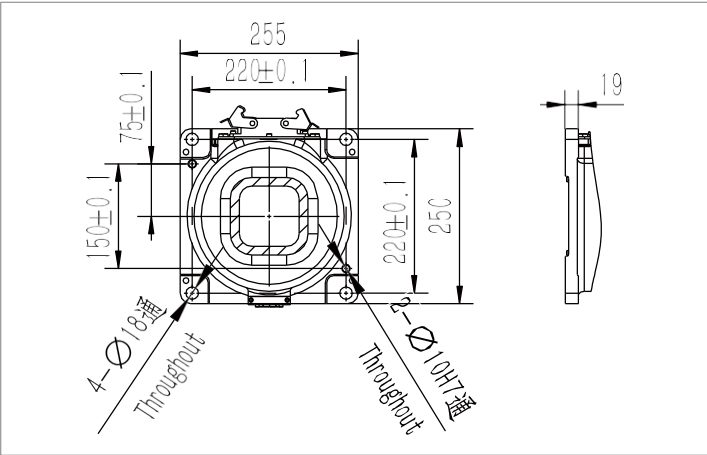

END FLANGE MOUNTING SIZE

